



10, Alwen Court Pages Walk, London, SE1 4GU
£2,500 Per month



10, Alwen Court Pages Walk, London, SE1 4GU

£2,500 Per month

Introducing Alwen Court, an exquisite unfurnished 1-bedroom, 1-bathroom apartment with a balcony that overlooks beautifully landscaped gardens. Situated in the highly sought-after SE1 4GU neighborhood, this contemporary residence offers an exceptional living experience, enhanced by the presence of a dedicated daytime concierge service.

As you step inside, you'll be captivated by the bright and welcoming living space, filled with an abundance of natural light. The well-appointed kitchen, complete with modern appliances and sleek countertops, sets the stage for culinary creativity. The spacious living area provides ample room for relaxation and entertainment, while the balcony serves as an idyllic retreat, offering panoramic views of the meticulously manicured gardens.

The bedroom of Alwen Court is a sanctuary of tranquility, providing a serene ambiance for restful nights. The bathroom boasts stylish fixtures and a refreshing atmosphere, ensuring a rejuvenating start or end to your day.

The convenience of a dedicated daytime concierge service adds an extra layer of luxury to your living experience at Alwen Court. Their attentive assistance during regular business hours ensures that your needs are met promptly and efficiently.

Description

Introducing Alwen Court, an exquisite unfurnished 1-bedroom, 1-bathroom apartment with a balcony that overlooks beautifully landscaped gardens. Situated in the highly sought-after SE1 4GU neighborhood, this contemporary residence offers an exceptional living experience, enhanced by the presence of a dedicated daytime concierge service.

As you step inside, you'll be captivated by the bright and welcoming living space, filled with an abundance of natural light. The well-appointed kitchen, complete with modern appliances and sleek countertops, sets the stage for culinary creativity. The spacious living area provides ample room for relaxation and entertainment, while the balcony serves as an idyllic retreat, offering panoramic views of the meticulously manicured gardens.

The bedroom of Alwen Court is a sanctuary of tranquility, providing a serene ambiance for restful nights. The bathroom boasts stylish fixtures and a refreshing atmosphere, ensuring a rejuvenating start or end to your day.

The convenience of a dedicated daytime concierge service adds an extra layer of luxury to your living experience at Alwen Court. Their attentive assistance during regular business hours ensures that your needs are met promptly and efficiently.

Situation

Located within walking distance of the iconic Tower Bridge, Alwen Court places you at the heart of one of London's most renowned landmarks. The neighborhood is brimming with an array of trendy cafes, restaurants, and shops, allowing you to indulge in the vibrant local scene. Excellent public transportation links from local busses provide easy access to the city center and beyond, making commuting a breeze.

This unfurnished 1-bedroom apartment at Alwen Court is a rare find, offering a seamless blend of comfort, style, and convenience. Don't miss the opportunity to make this exceptional residence your new home. Contact us today to arrange a viewing and discover the unmatched allure of Alwen Court.

Unfurnished

Council Tax Band: D

Available: 21st June 2026



Floor Plans

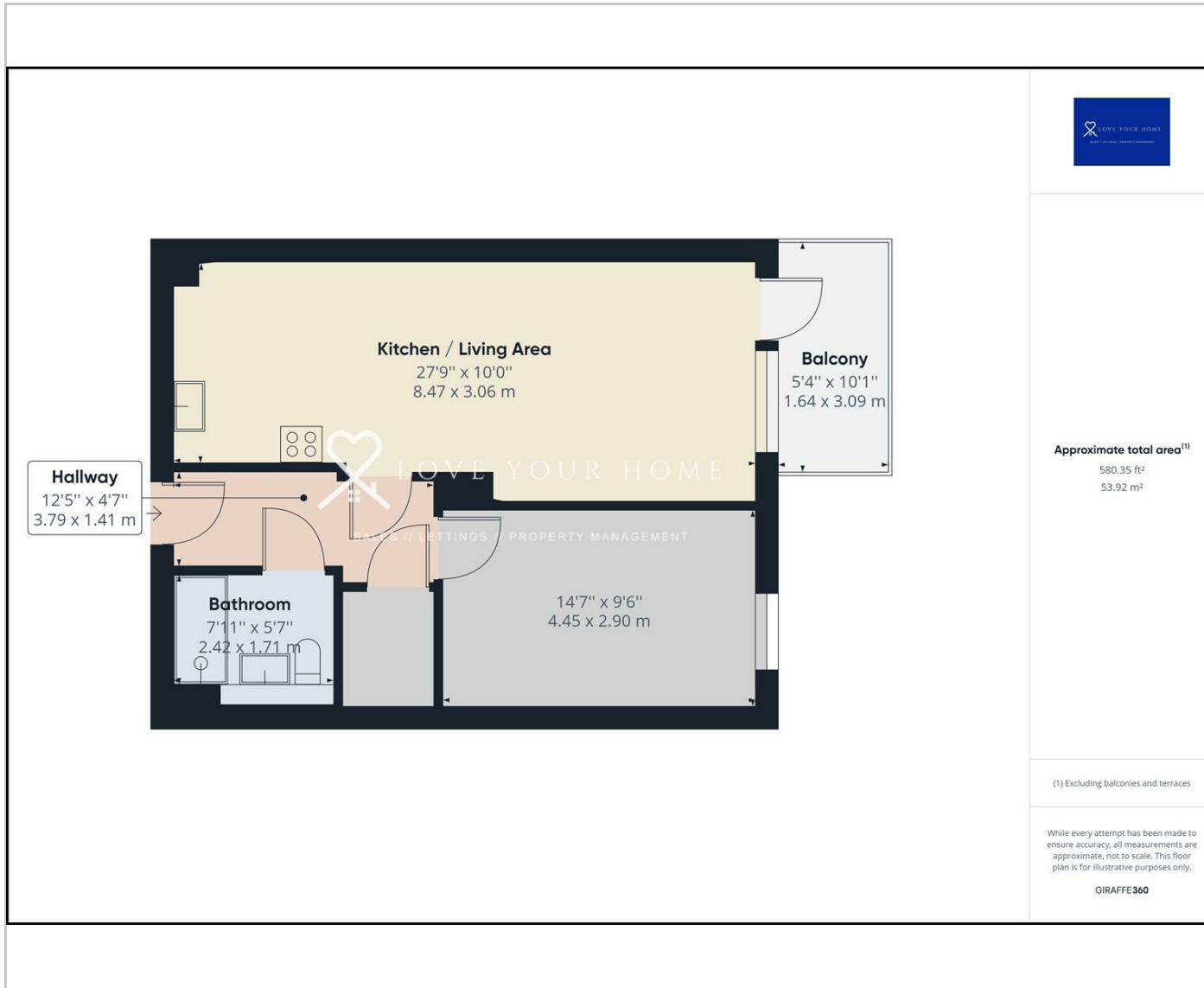

Area Map

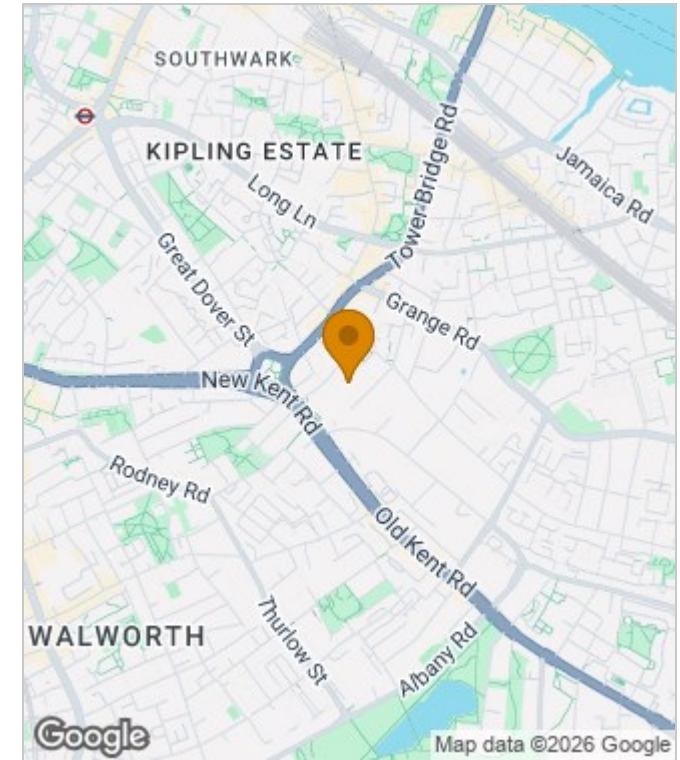

Energy Performance Graph

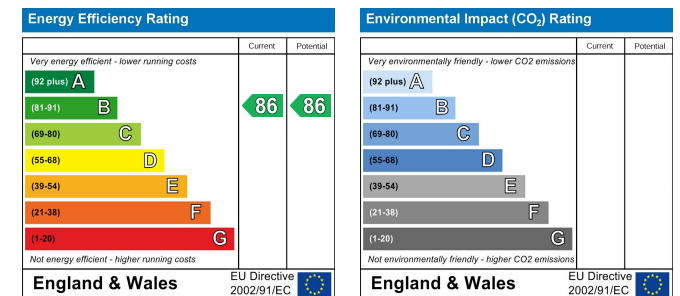

These particulars, whilst believed to be accurate are set out as a general outline only for guidance and do not constitute any part of an offer or contract. Intending purchasers should not rely on them as statements of representation of fact, but must satisfy themselves by inspection or otherwise as to their accuracy. No person in this firm's employment has the authority to make or give any representation or warranty in respect of the property.